



# South Campus Revitalization Plan



## CREATE

Downtown Campus by moving the JSMBS from South Campus





## REVITALIZE

### South Campus as a Professional Education Campus

- Move The School of Social Work (SW) and Graduate School of Education (GSE).
- Address space needs of growing schools
- Demolish temporary and vacant buildings



## REIMAGINE

### North Campus as an Undergraduate and Research Center

- Address academic and research space needs of growing STEM programs in particular for the School of Engineering & Applied Sciences and the College of Arts & Sciences
- Increase centrally scheduled classrooms across campus



## IMPROVE

the campus life experience at all three centers

- Create Heart of the Campus centers
- Improve library and student experiences
- Enhance/create recreation options





## REDUCE

deferred maintenance and address priority infrastructure

- Align deferred maintenance needs with strategic projects



# Revitalization Plan for SOUTH CAMPUS

## Programmatic Alignments

- Move Graduate School of Education
- Relocate School of Social Work to Parker Hall
- Consolidate School of Public Health and Health Professions
- Consolidate School of Dental Medicine

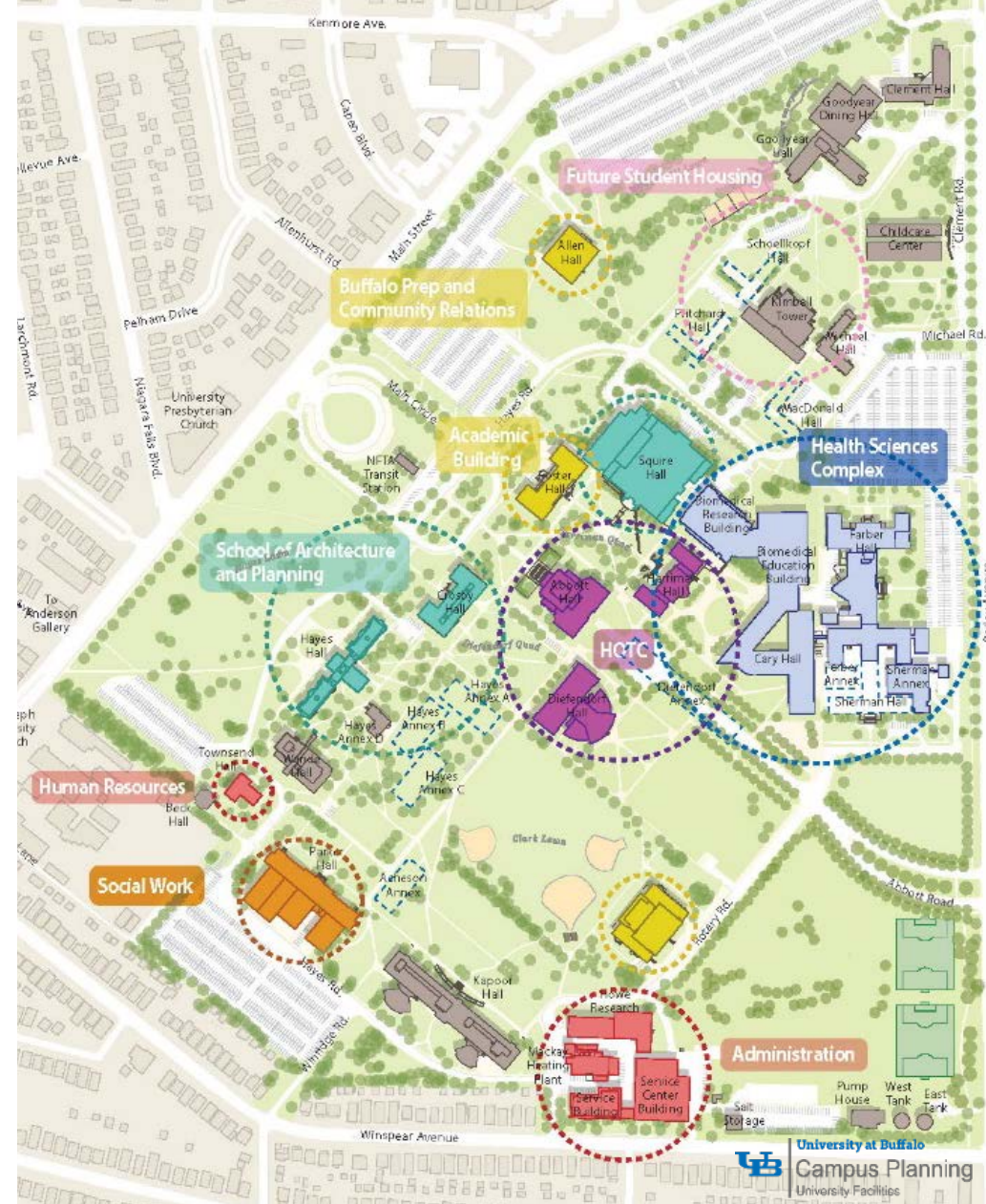



# Revitalization Plan for SOUTH CAMPUS

## Programmatic Alignments

- Improve School of Architecture & Planning facilities
- Create vibrant Heart of the Campus: library, classrooms, university services and recreation facilities

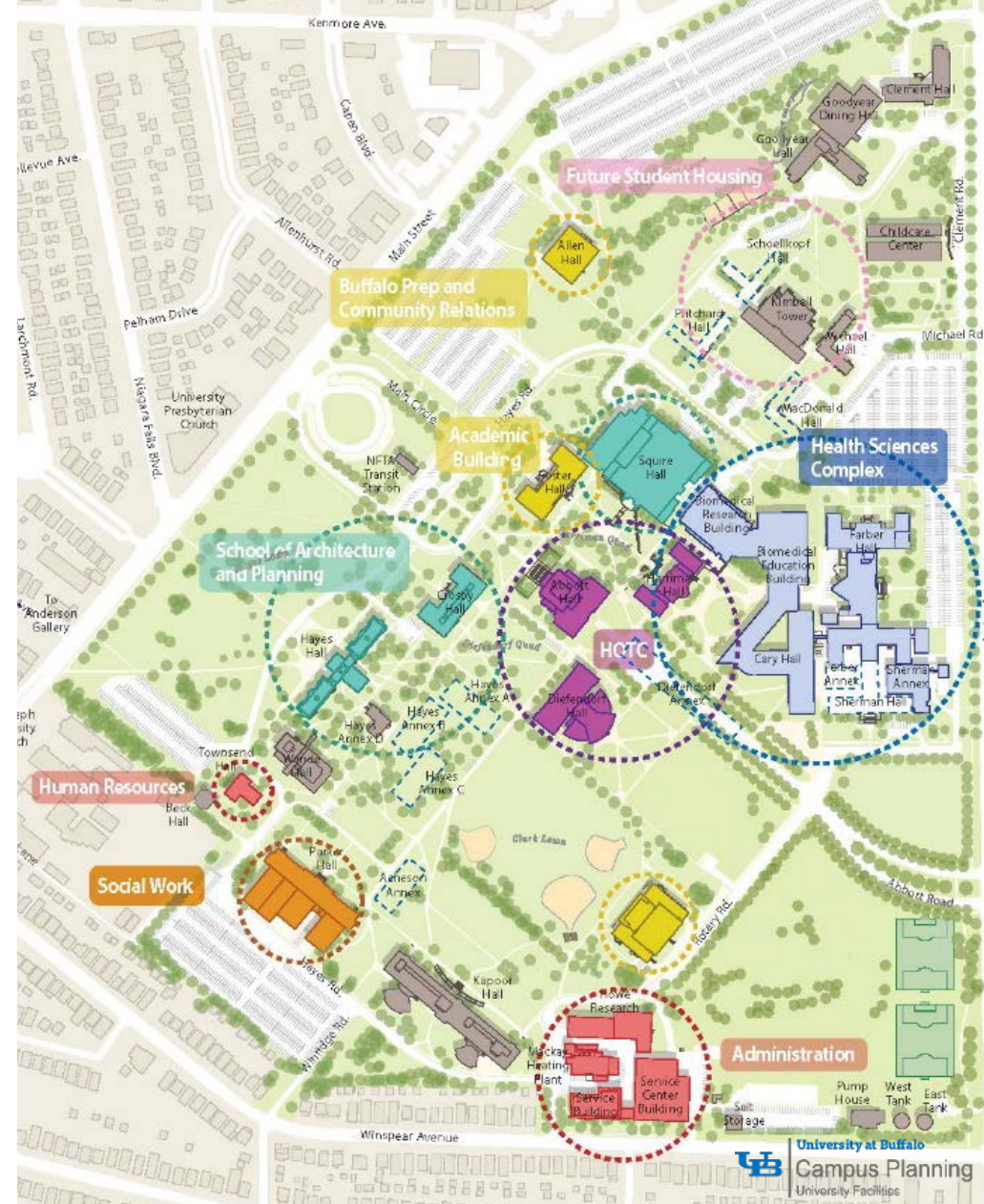



# Projects Completed

## Project List:

- Heart of the Campus: Abbott Hall Phase I
- Heart of the Campus: 1Diefendorf Phase I



Cafe



Student Services



University at Buffalo Student Study University Commons

# Projects In Process

## Completion Schedule:

- Abbott Hall: 2019
- Townsend Hall: 2020
- Allen Hall: 2020
- Crosby Hall: 2021
- Health Sciences Complex
  - Phase I: 2020
  - Phase II: 2024
- Parker Hall: 2022
- Foster Hall: 2022

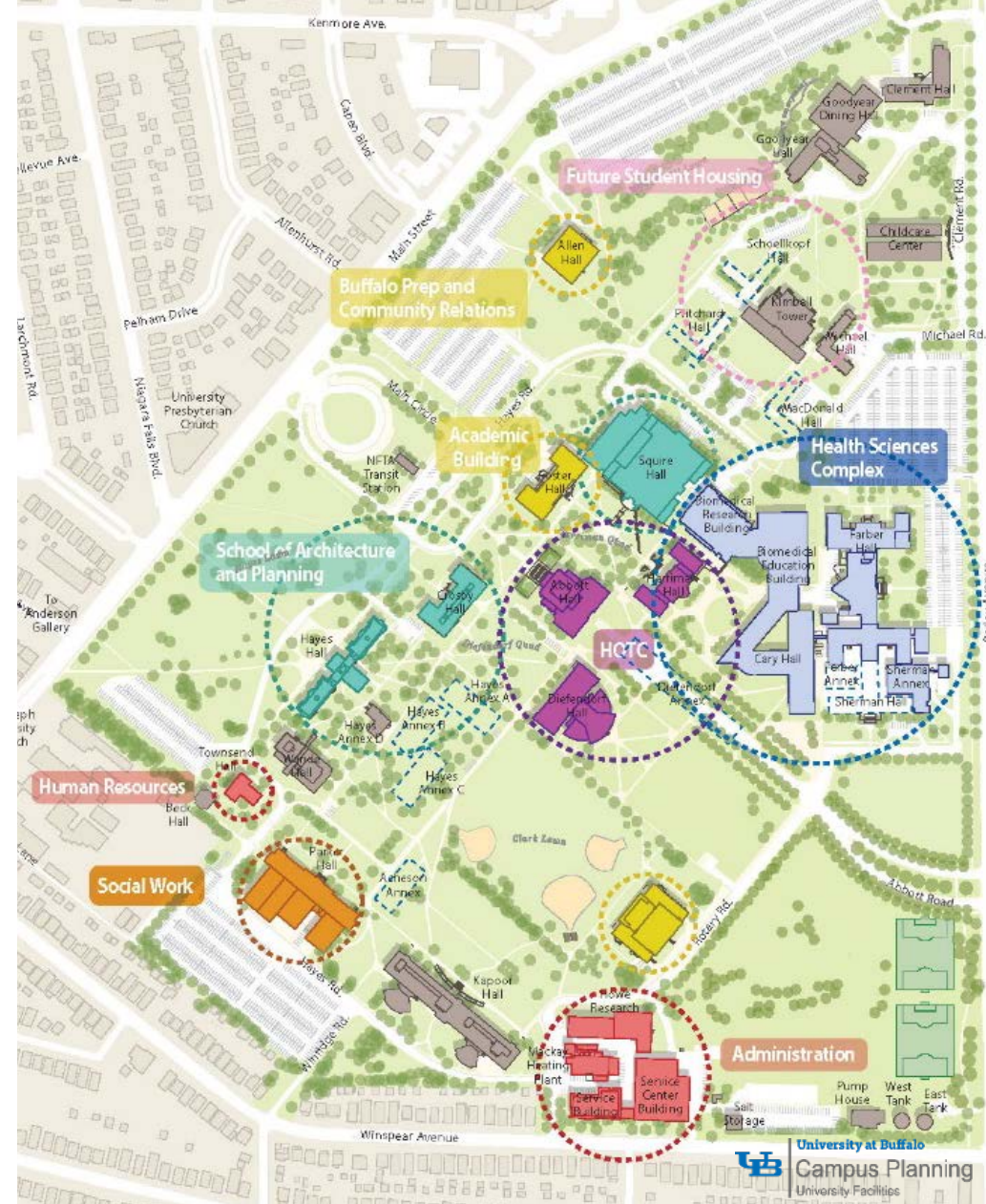



# Heart of the Campus: ABBOTT HALL Phase II

- New Cybrary - 3<sup>rd</sup> Floor
- Exhibition Space with Collaborative Study - 1<sup>st</sup> Floor
- Expected completion: 2019



# Human Resources: TOWNSEND HALL

- Phase I Completed April, 2019
- Phase II Projected Completion, 2020





# Community Relations & Buffalo Prep: ALLEN HALL



- ADA Renovations Completion: 2019
- Buffalo Prep Completion: 2020



# School of Architecture & Planning: CROSBY HALL



- Andrew Berman Architect
- Expected completion: 2021

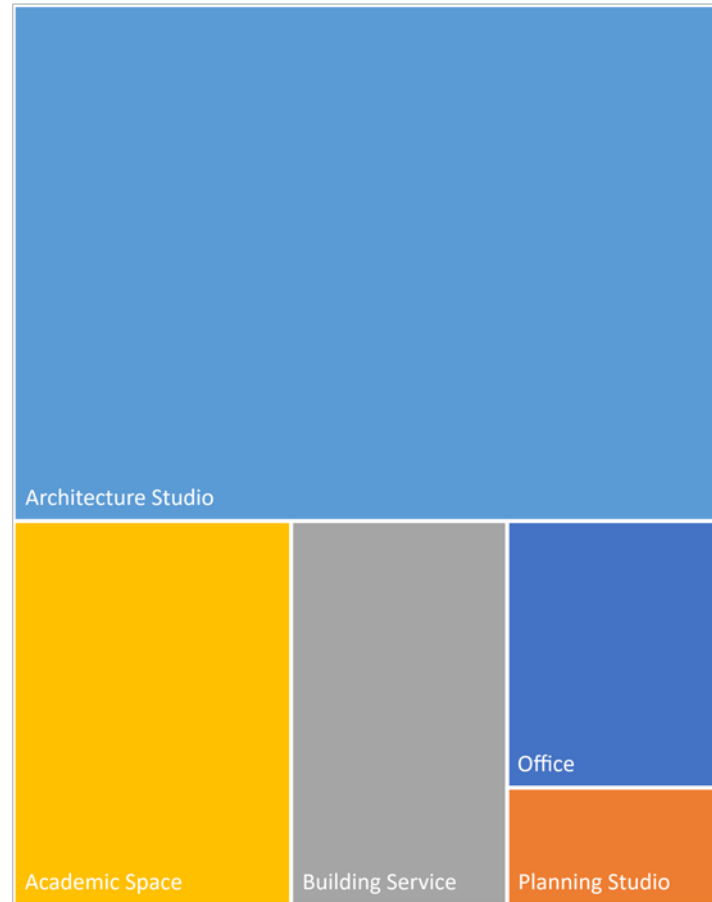



# School of Social Work: PARKER HALL



- Expected completion: 2023

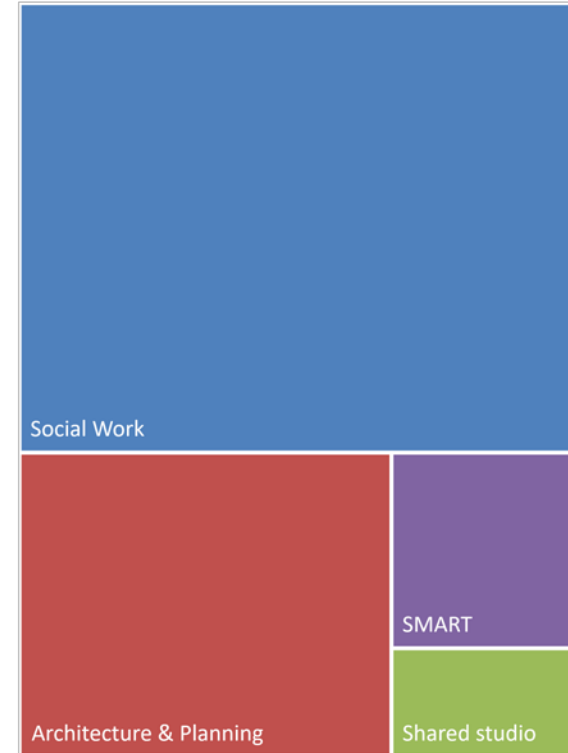

# Consolidate Dispersed Programs: HEALTH SCIENCES COMPLEX

## Parker Hall:

Nuclear Medicine (JSMBS)  
Biosurfaces (SDM)

## Abbott Hall:

Pharmacy

## Diefendorf Hall:

Center for Children & Families (CAS)

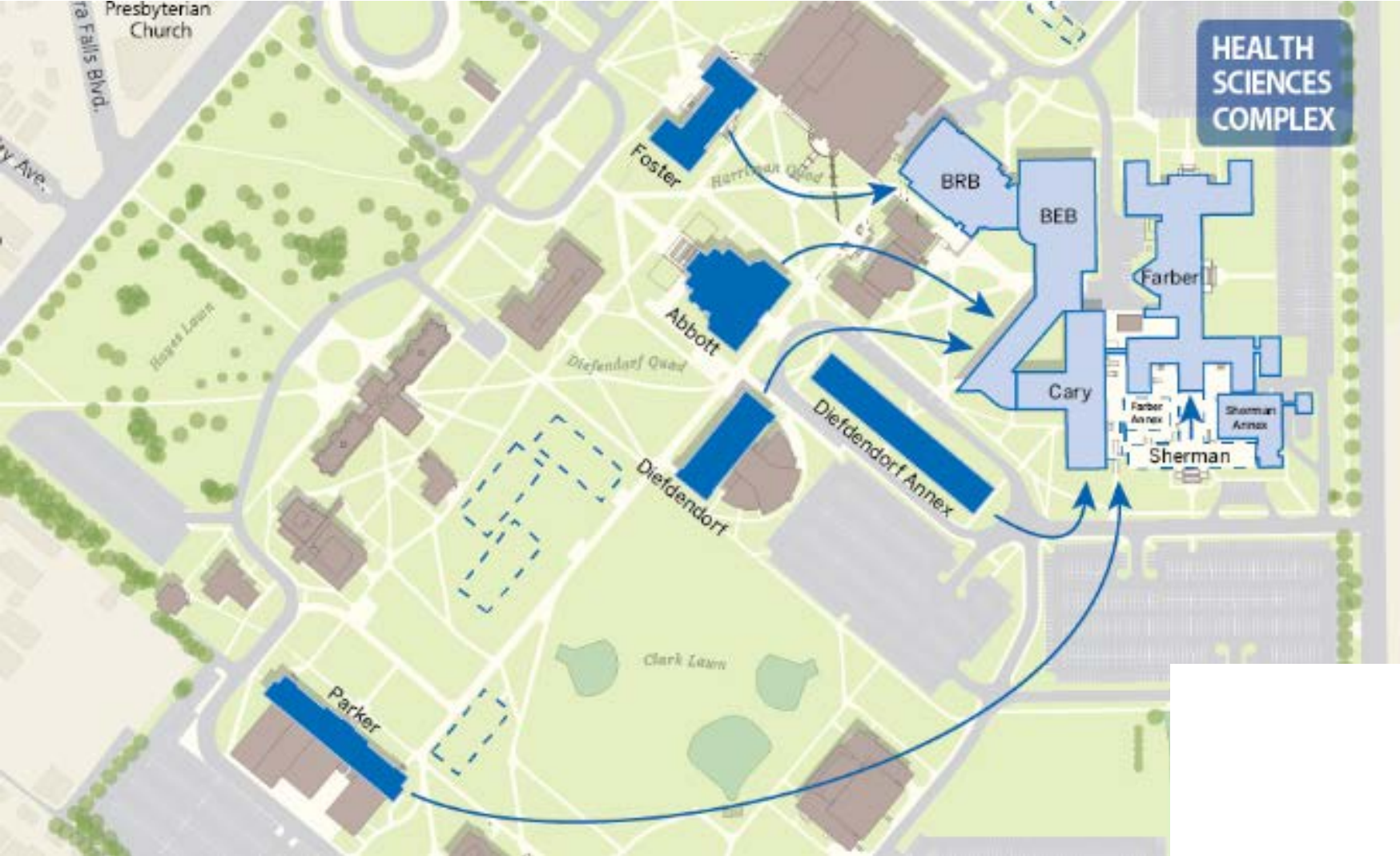



# HEALTH SCIENCES COMPLEX BACKFILL:

## BIOMEDICAL RESEARCH BUILDING

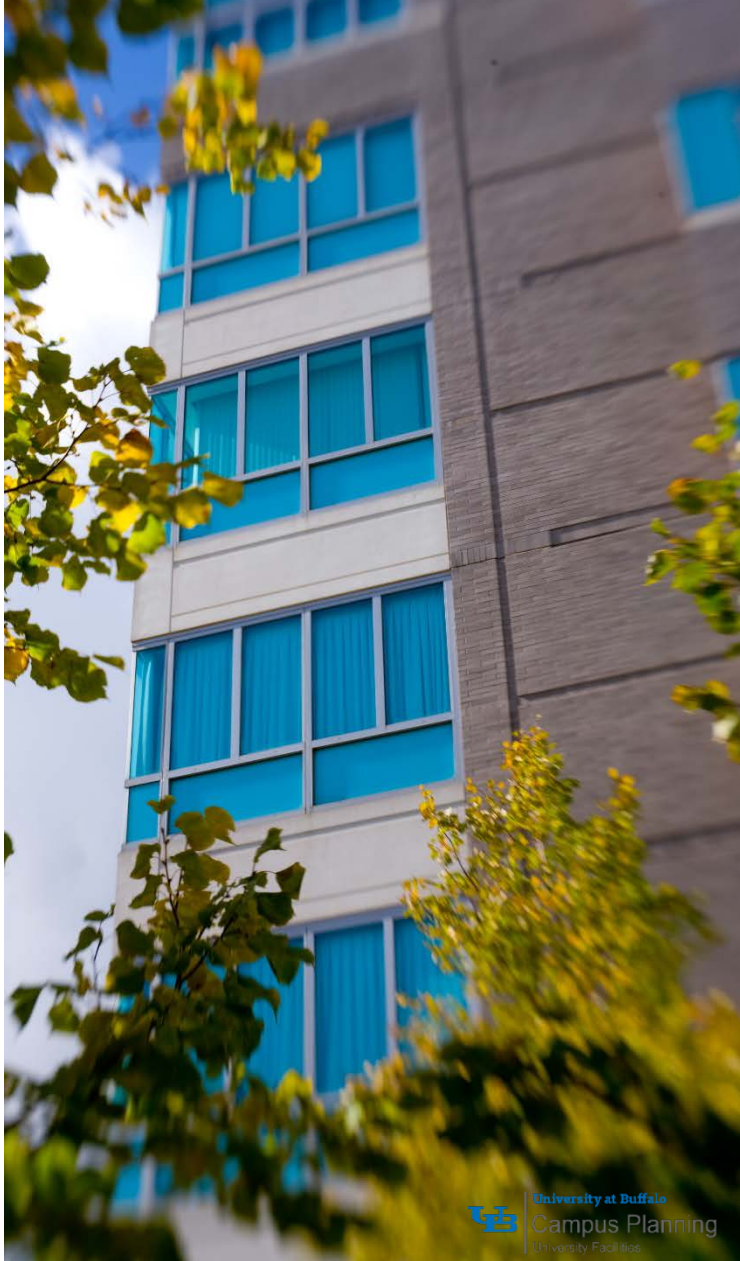
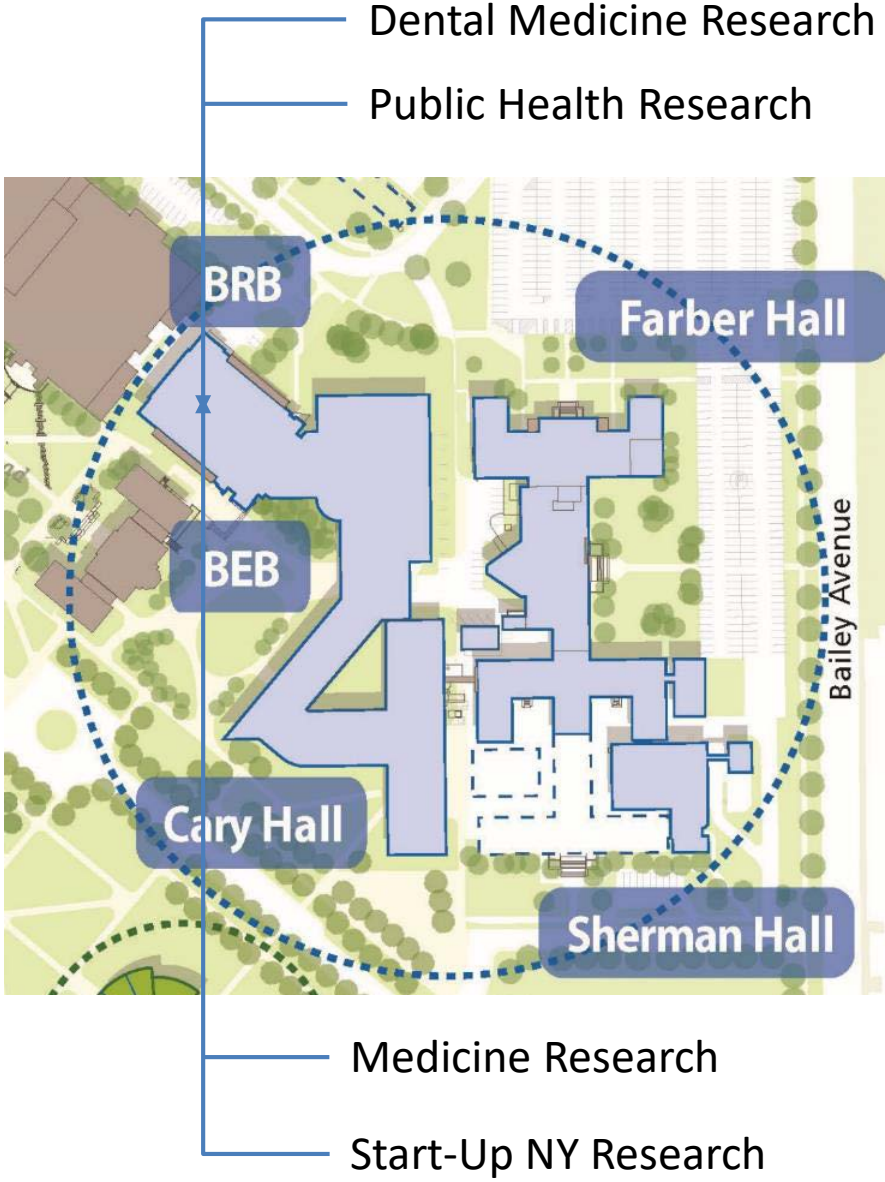

# HEALTH SCIENCES COMPLEX BACKFILL:

## BIOMEDICAL EDUCATION BUILDING

JSMBS, Undergraduate  
Advising & Education Center

SPHHP Dean's Office &  
Biostatistics

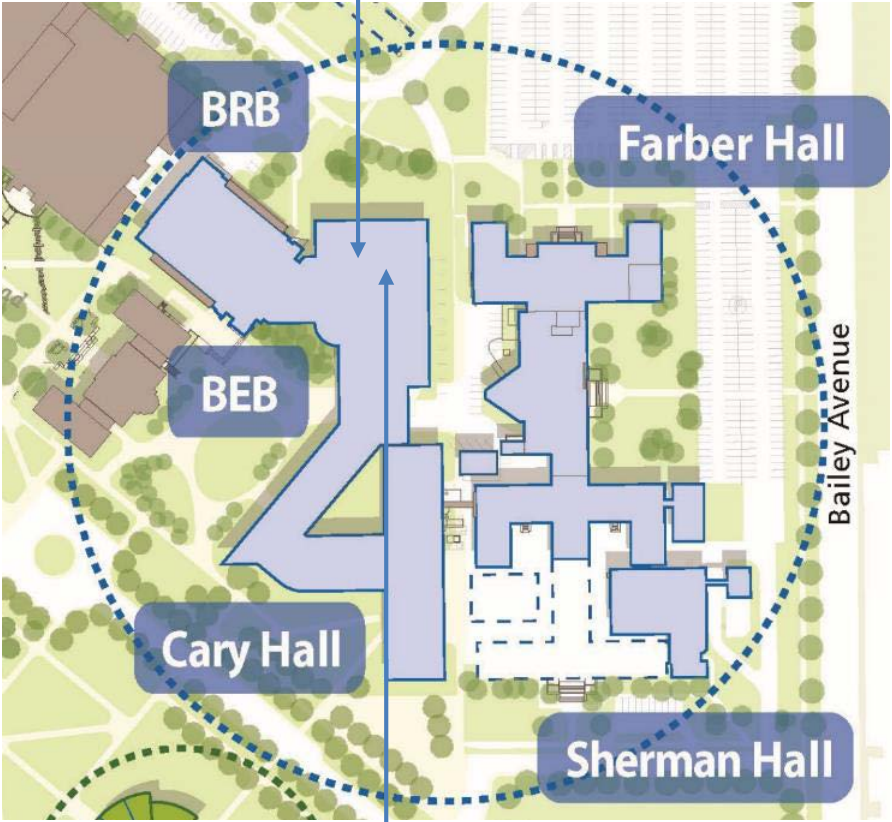

CAS

General Education





# HEALTH SCIENCES COMPLEX BACKFILL:

## FARBER HALL

- Clinical research
- JSMBS, BCLS research
- SPHHP various departments

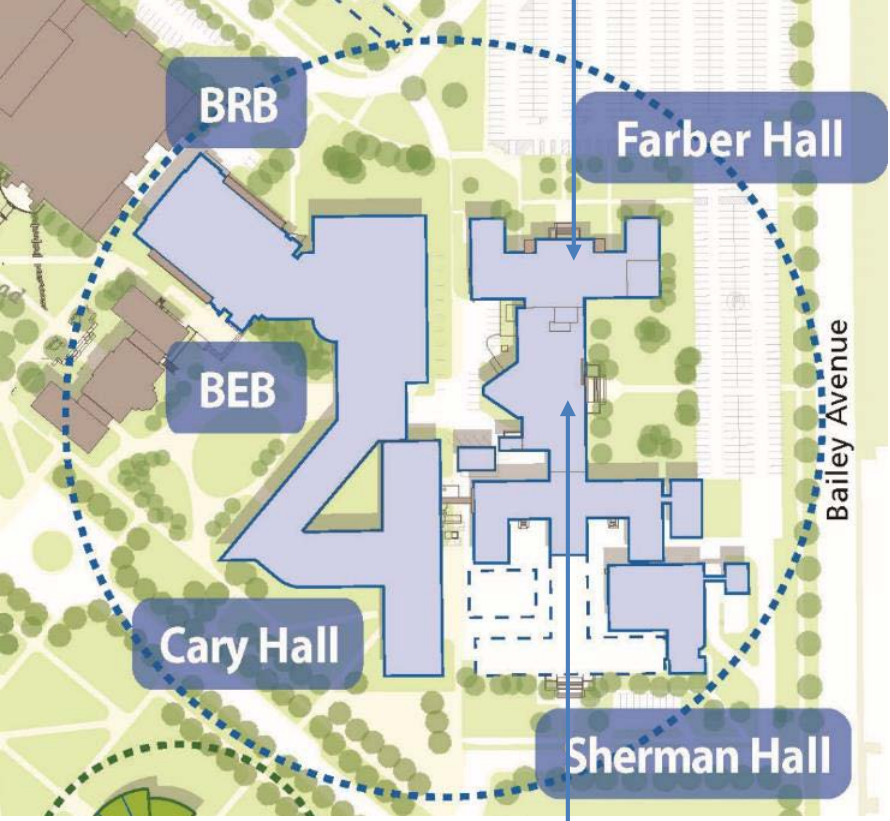

General education





# HEALTH SCIENCES COMPLEX BACKFILL:

## CARY HALL

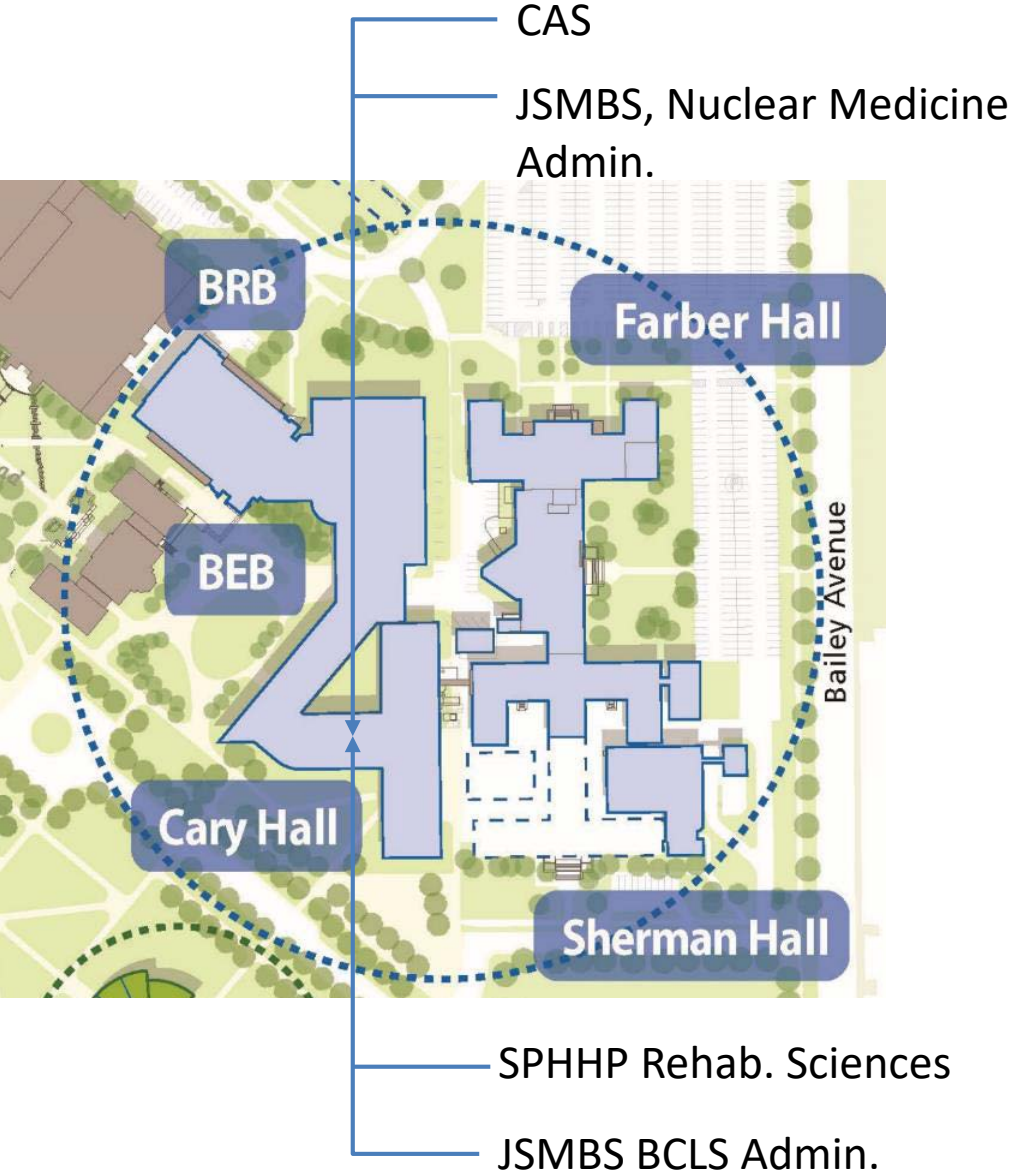



# HEALTH SCIENCES COMPLEX BACKFILL

## Health Sciences Complex Backfill

### Project Durations by School\*

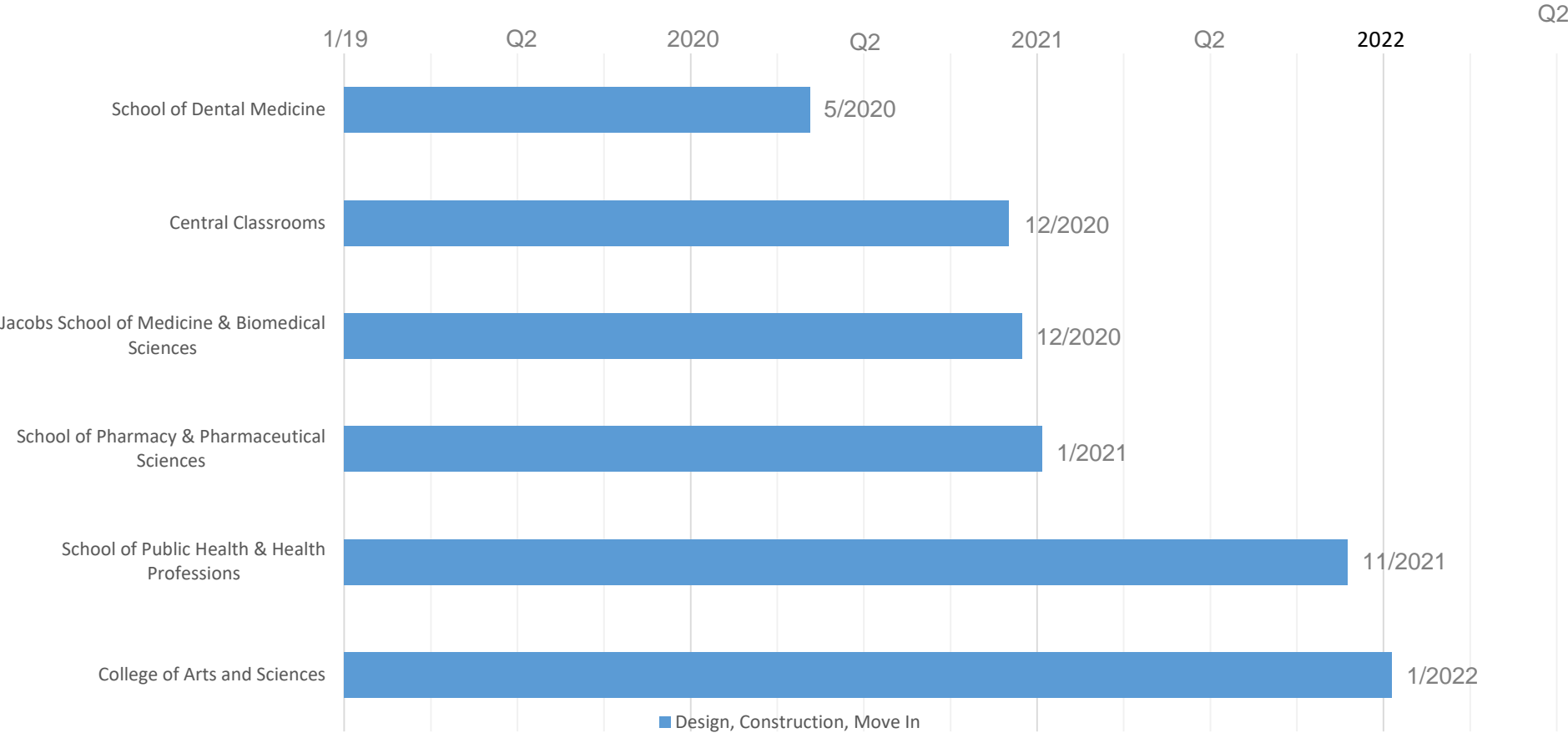

\* project durations adjusted based on a January 2019 start date for all



# Landscape Projects: Memorial Garden





# Demolition of Structures: TRIADS

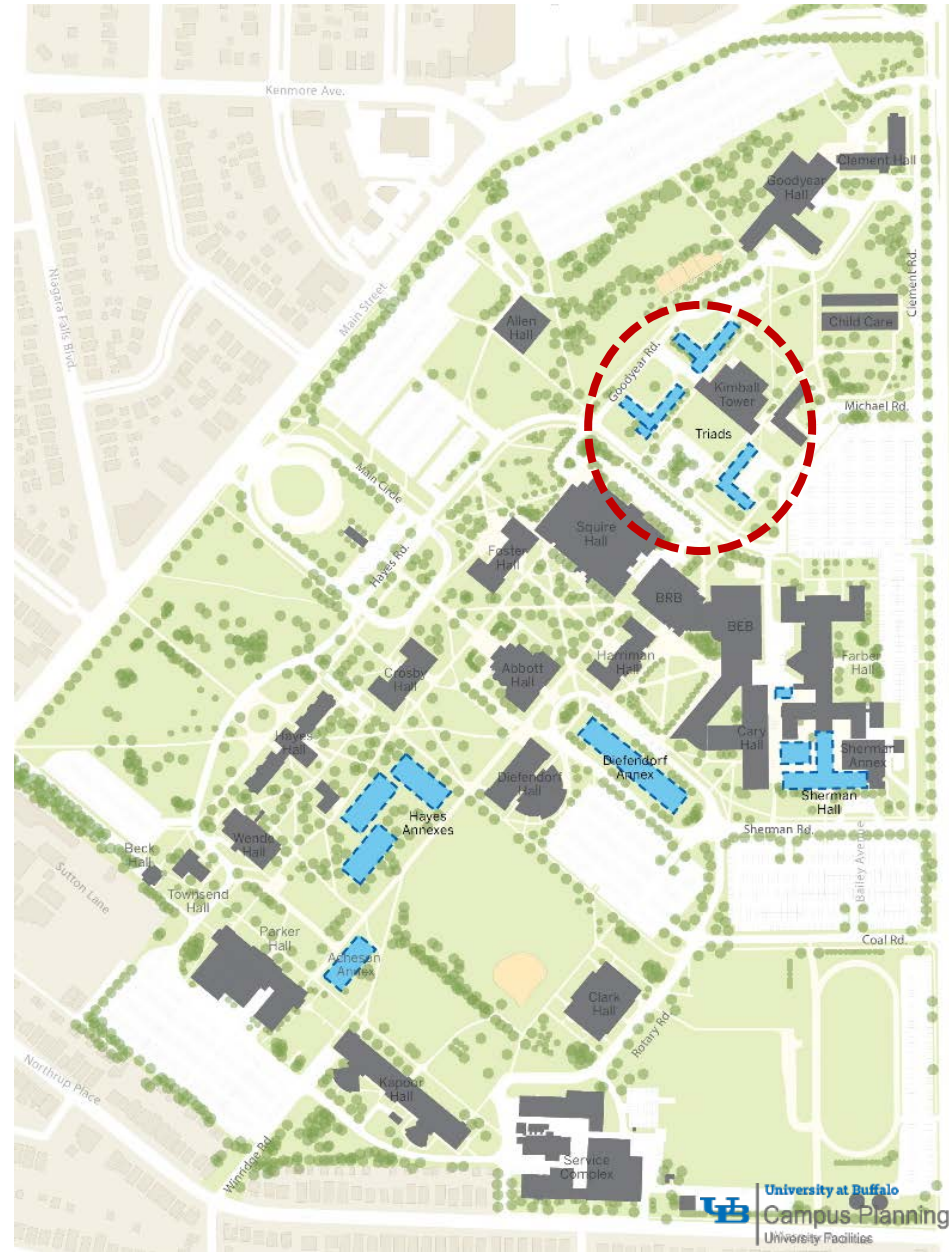



# Future Projects: Demolition of Structures

## Future Demolition:

- Hayes Annex A, B, C
- Acheson Annex
- Diefendorf Annex
- Farber Annex
- Sherman Hall

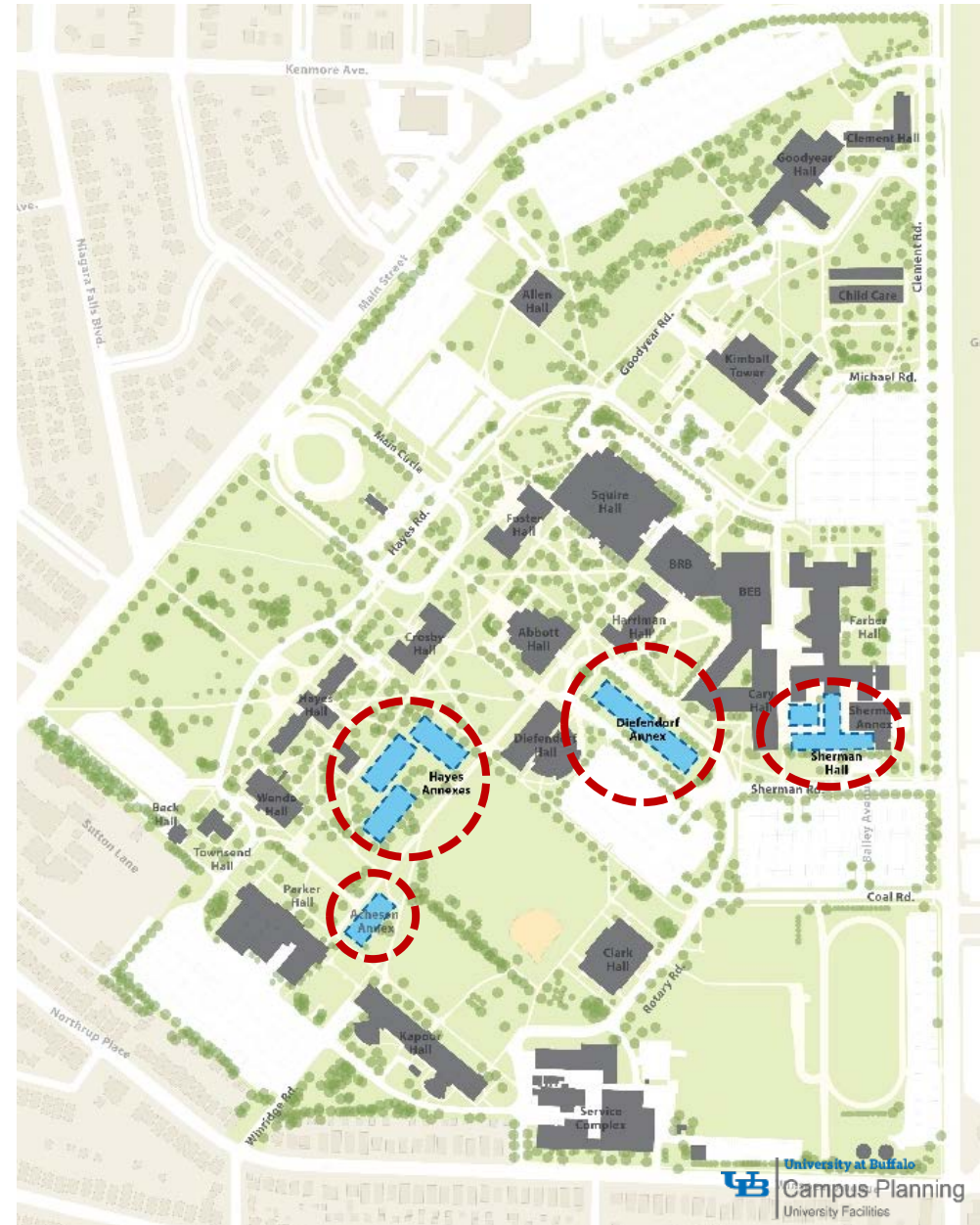



# Future Projects: Demolition of Structures



Dorms being demolished

Hayes Annexes open until Crosby Renovation

Diefendorf Annex closed Sept 14

Acheson Annex open until Buffalo Prep move



# Future Projects: Restored Campus Landscapes





# Future Projects: Create New Bailey Ave Entrance



# Future Projects: Create New Bailey Ave Entrance





# Upcoming Landscape Projects: Banners







# South Campus Revitalization Plan

